

Attachment 1: Overshadowing diagrams by City Plan

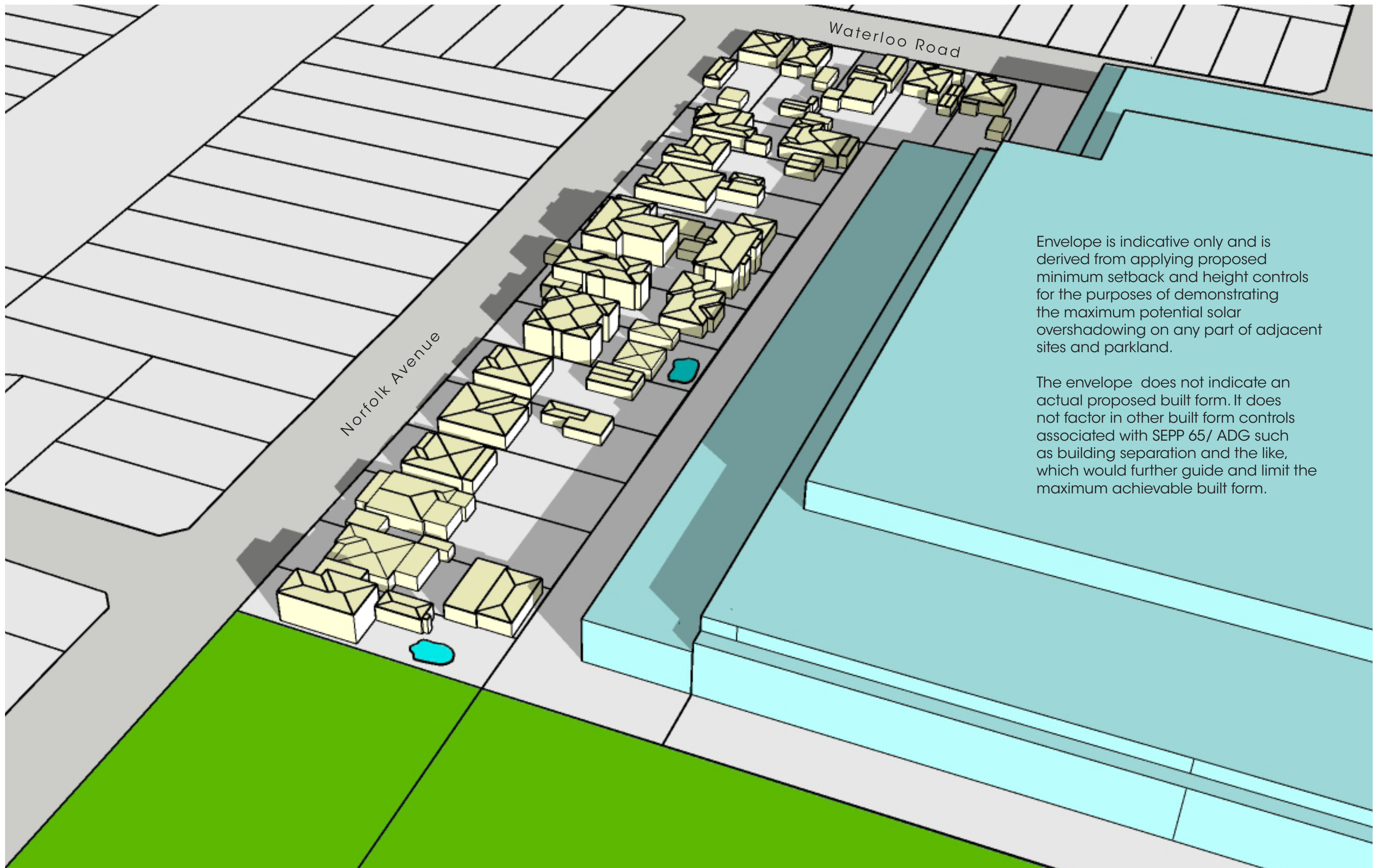

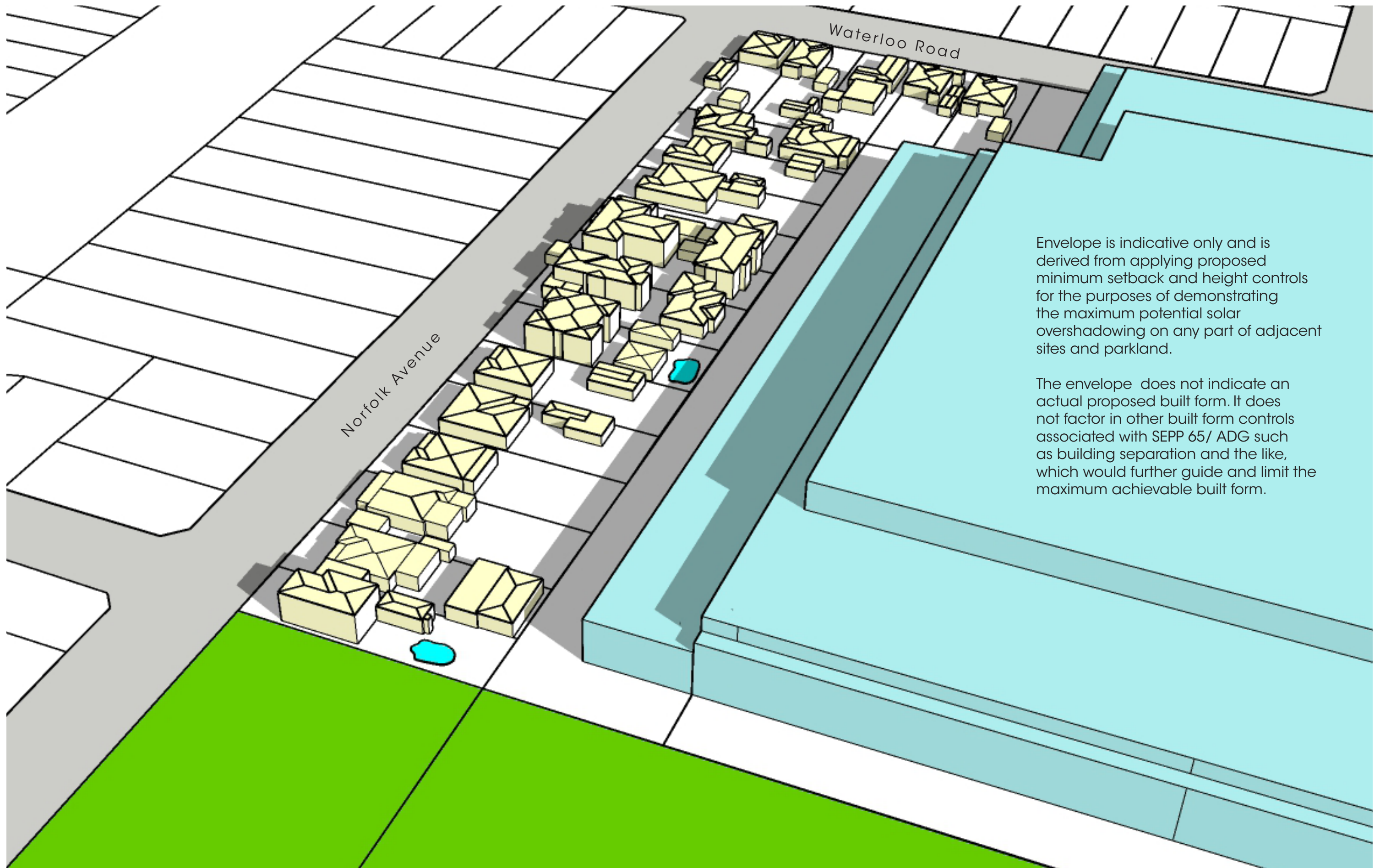

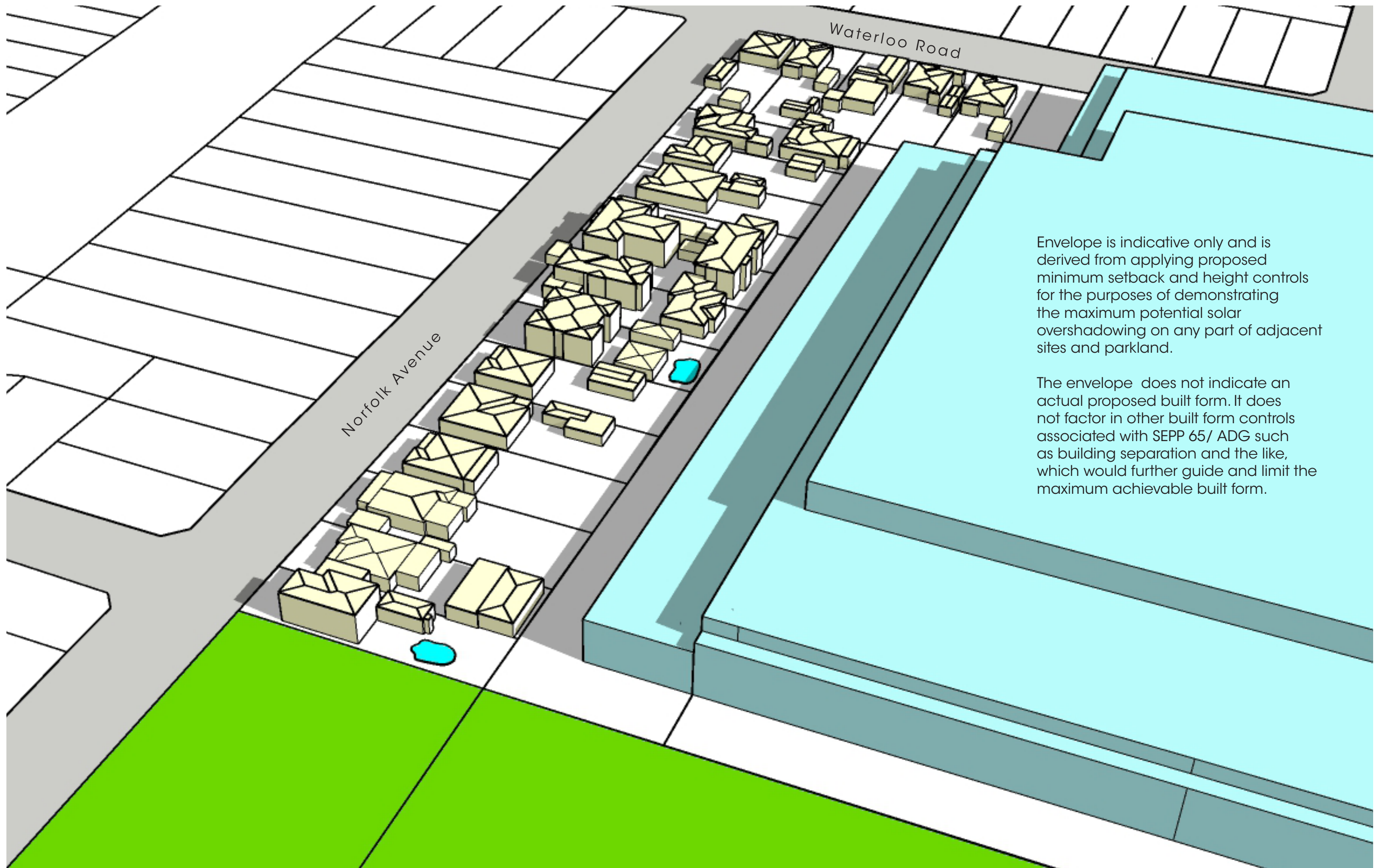

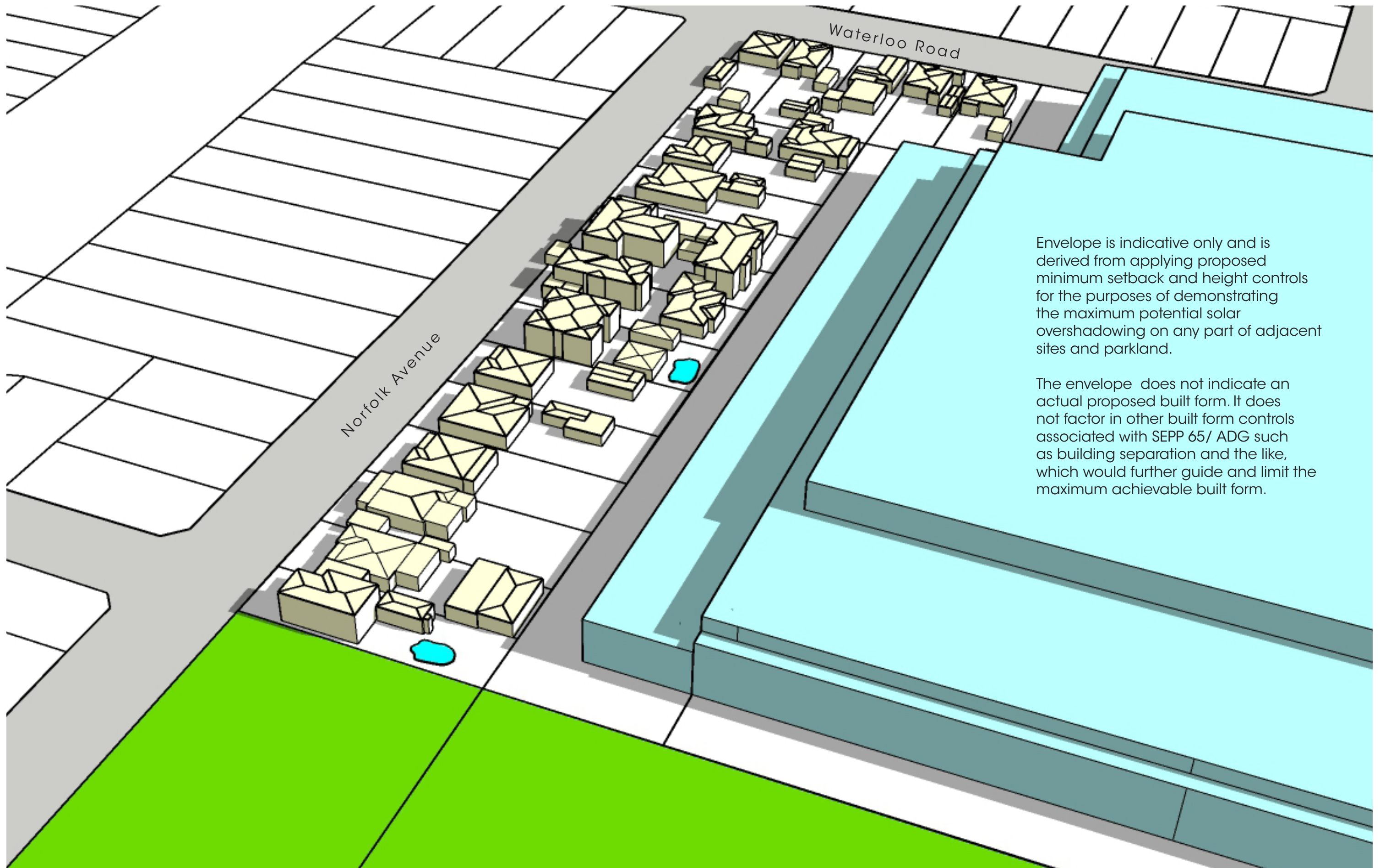

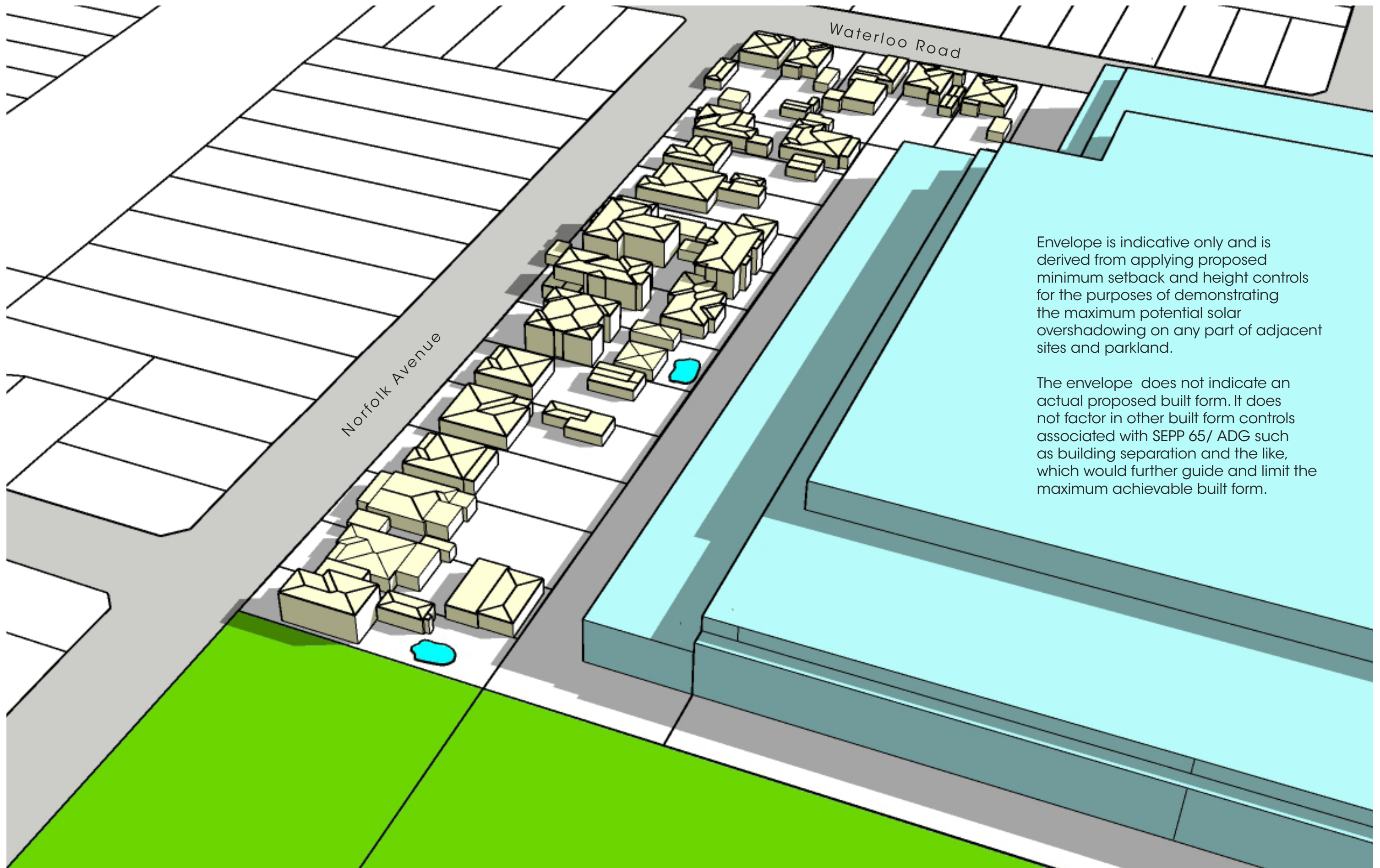

Envelope is indicative only and is derived from applying proposed minimum setback and height controls for the purposes of demonstrating the maximum potential solar overshadowing on any part of adjacent sites and parkland.

The envelope does not indicate an actual proposed built form. It does not factor in other built form controls associated with SEPP 65/ ADG such as building separation and the like, which would further guide and limit the maximum achievable built form.

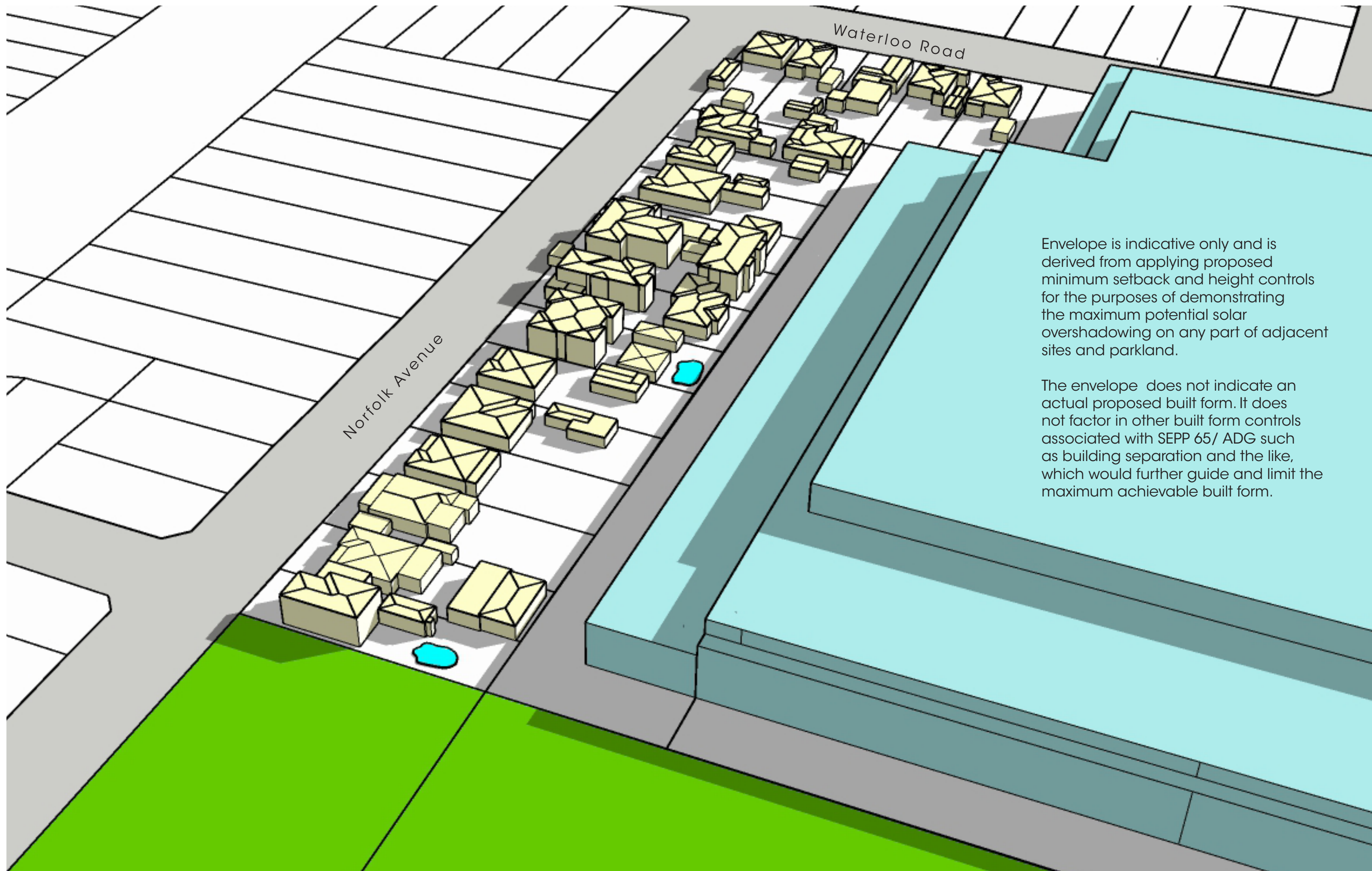

Envelope is indicative only and is derived from applying proposed minimum setback and height controls for the purposes of demonstrating the maximum potential solar overshadowing on any part of adjacent sites and parkland.

The envelope does not indicate an actual proposed built form. It does not factor in other built form controls associated with SEPP 65/ ADG such as building separation and the like, which would further guide and limit the maximum achievable built form.

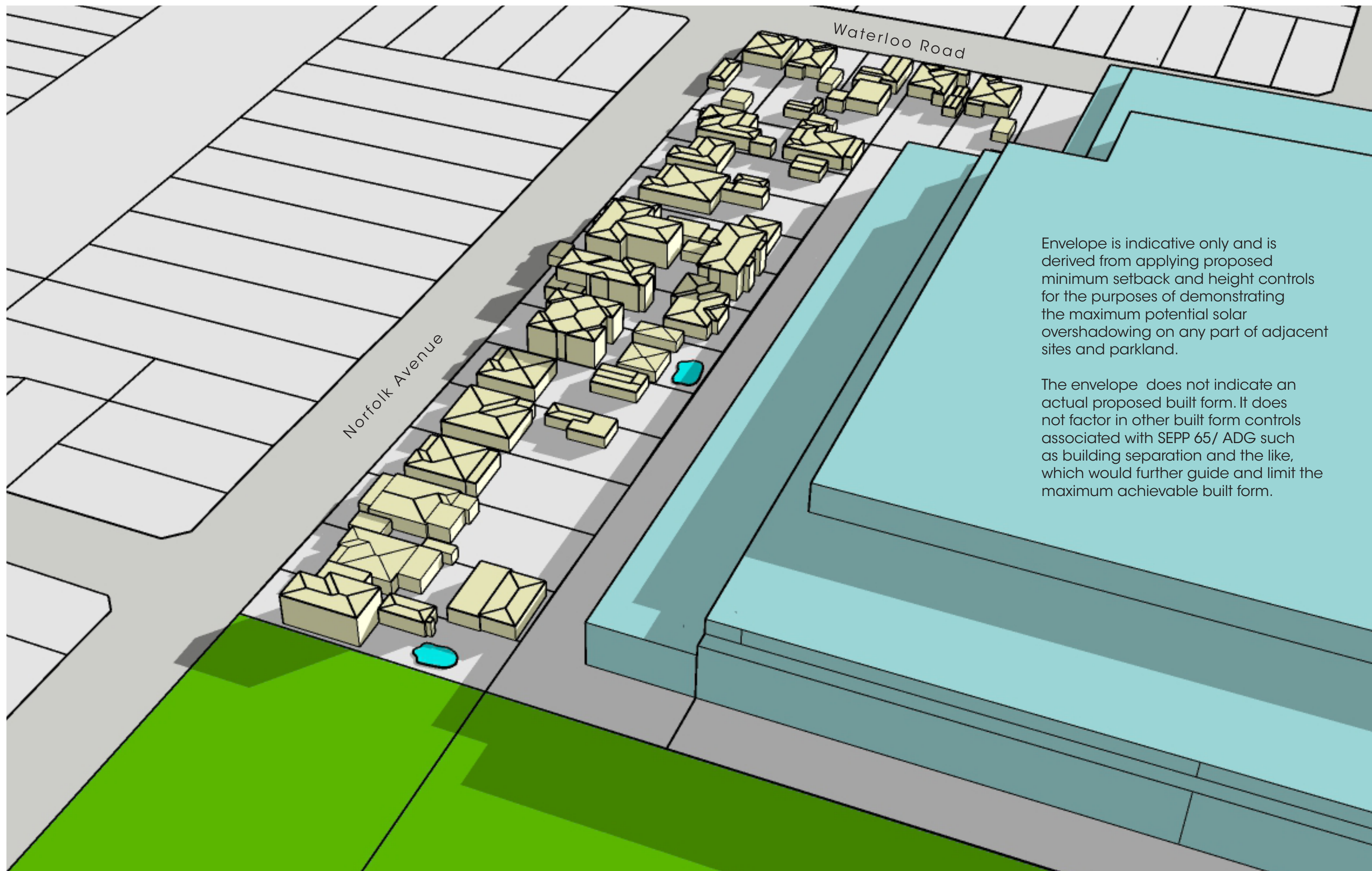

Envelope is indicative only and is derived from applying proposed minimum setback and height controls for the purposes of demonstrating the maximum potential solar overshadowing on any part of adjacent sites and parkland.

The envelope does not indicate an actual proposed built form. It does not factor in other built form controls associated with SEPP 65/ ADG such as building separation and the like, which would further guide and limit the maximum achievable built form.

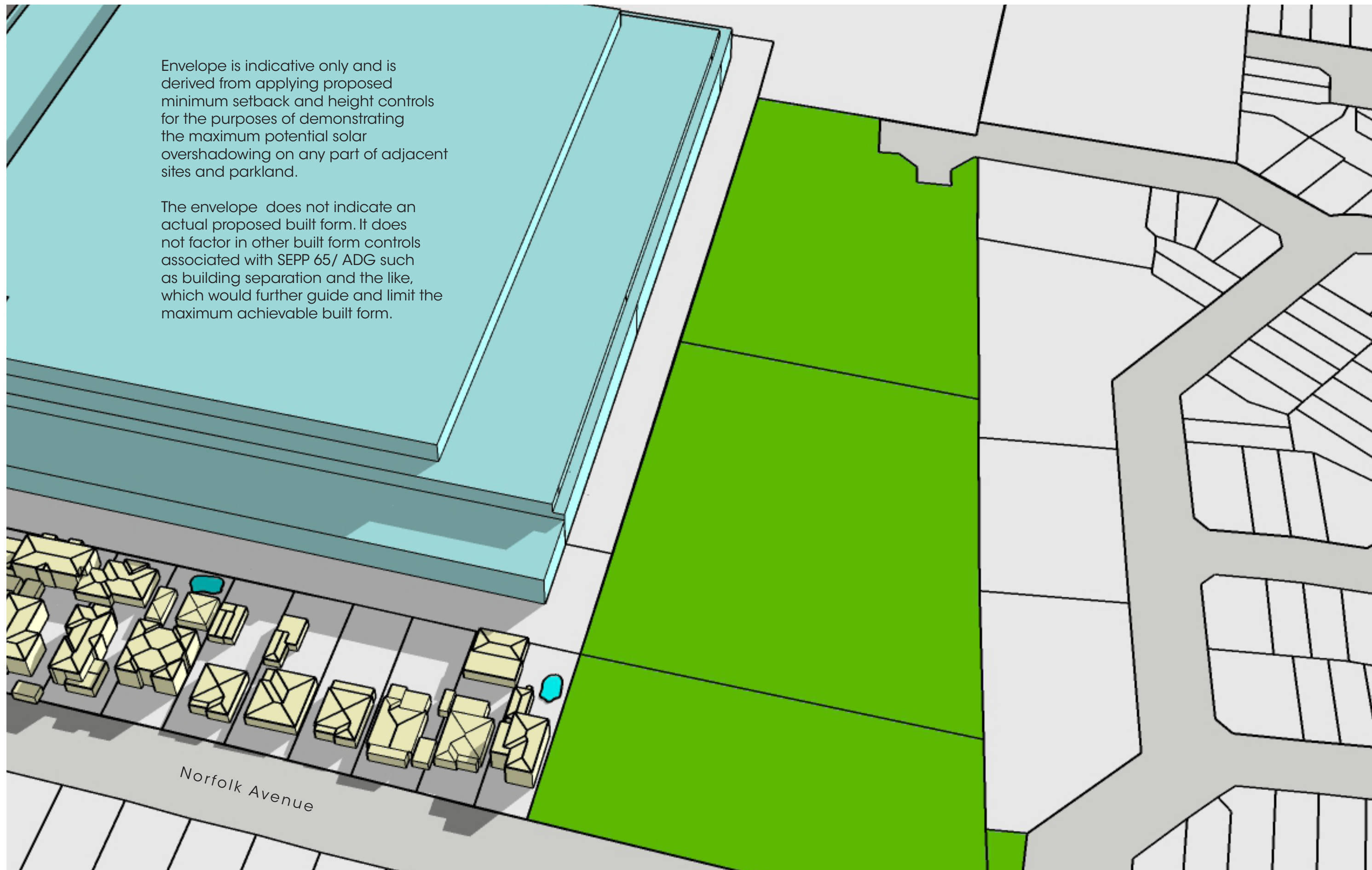

Envelope is indicative only and is derived from applying proposed minimum setback and height controls for the purposes of demonstrating the maximum potential solar overshadowing on any part of adjacent sites and parkland.

The envelope does not indicate an actual proposed built form. It does not factor in other built form controls associated with SEPP 65/ ADG such as building separation and the like, which would further guide and limit the maximum achievable built form.

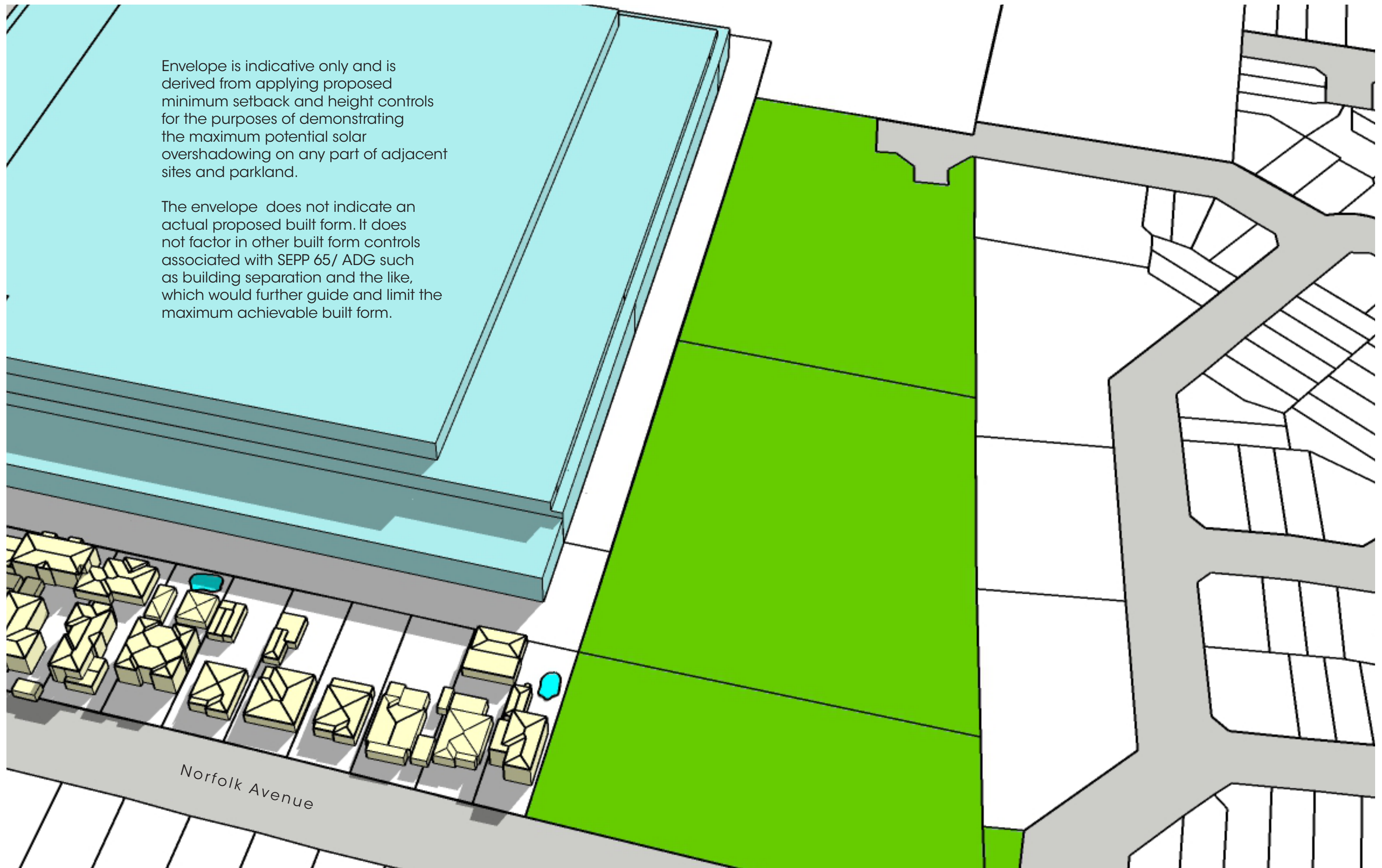

Envelope is indicative only and is derived from applying proposed minimum setback and height controls for the purposes of demonstrating the maximum potential solar overshadowing on any part of adjacent sites and parkland.

The envelope does not indicate an actual proposed built form. It does not factor in other built form controls associated with SEPP 65/ ADG such as building separation and the like, which would further guide and limit the maximum achievable built form.

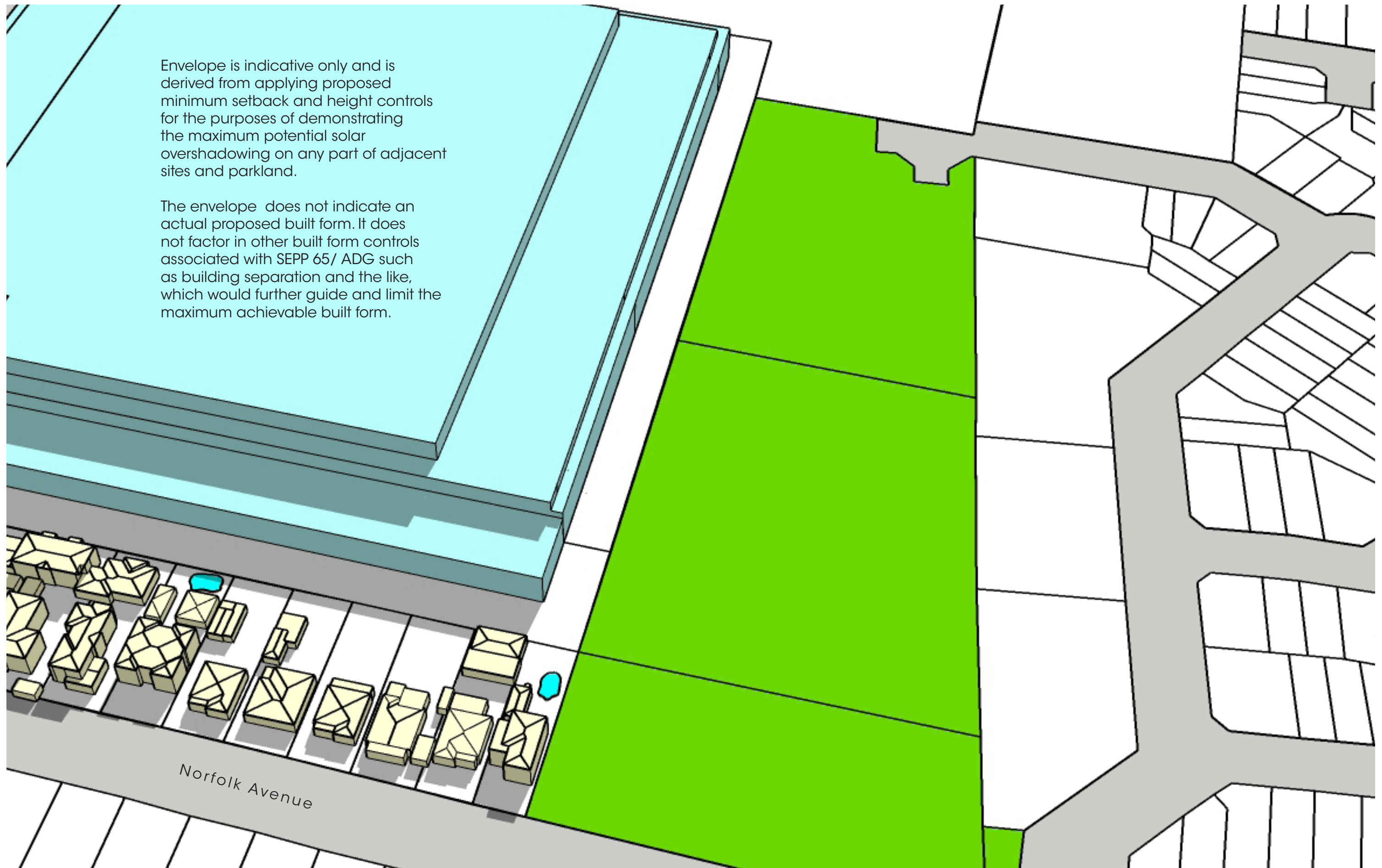

Envelope is indicative only and is derived from applying proposed minimum setback and height controls for the purposes of demonstrating the maximum potential solar overshadowing on any part of adjacent sites and parkland.

The envelope does not indicate an actual proposed built form. It does not factor in other built form controls associated with SEPP 65/ ADG such as building separation and the like, which would further guide and limit the maximum achievable built form.

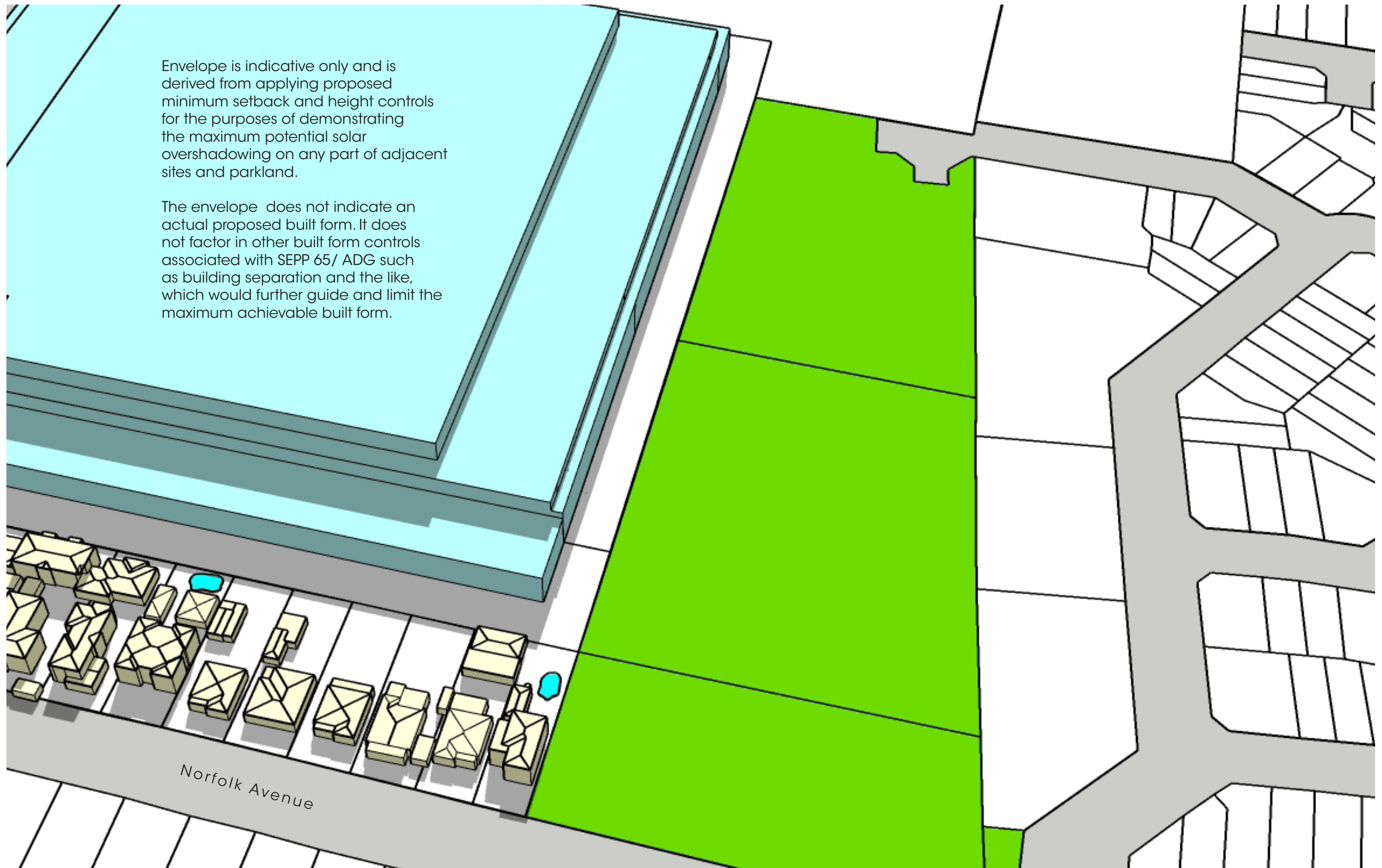

Envelope is indicative only and is derived from applying proposed minimum setback and height controls for the purposes of demonstrating the maximum potential solar overshadowing on any part of adjacent sites and parkland.

The envelope does not indicate an actual proposed built form. It does not factor in other built form controls associated with SEPP 65/ ADG such as building separation and the like, which would further guide and limit the maximum achievable built form.

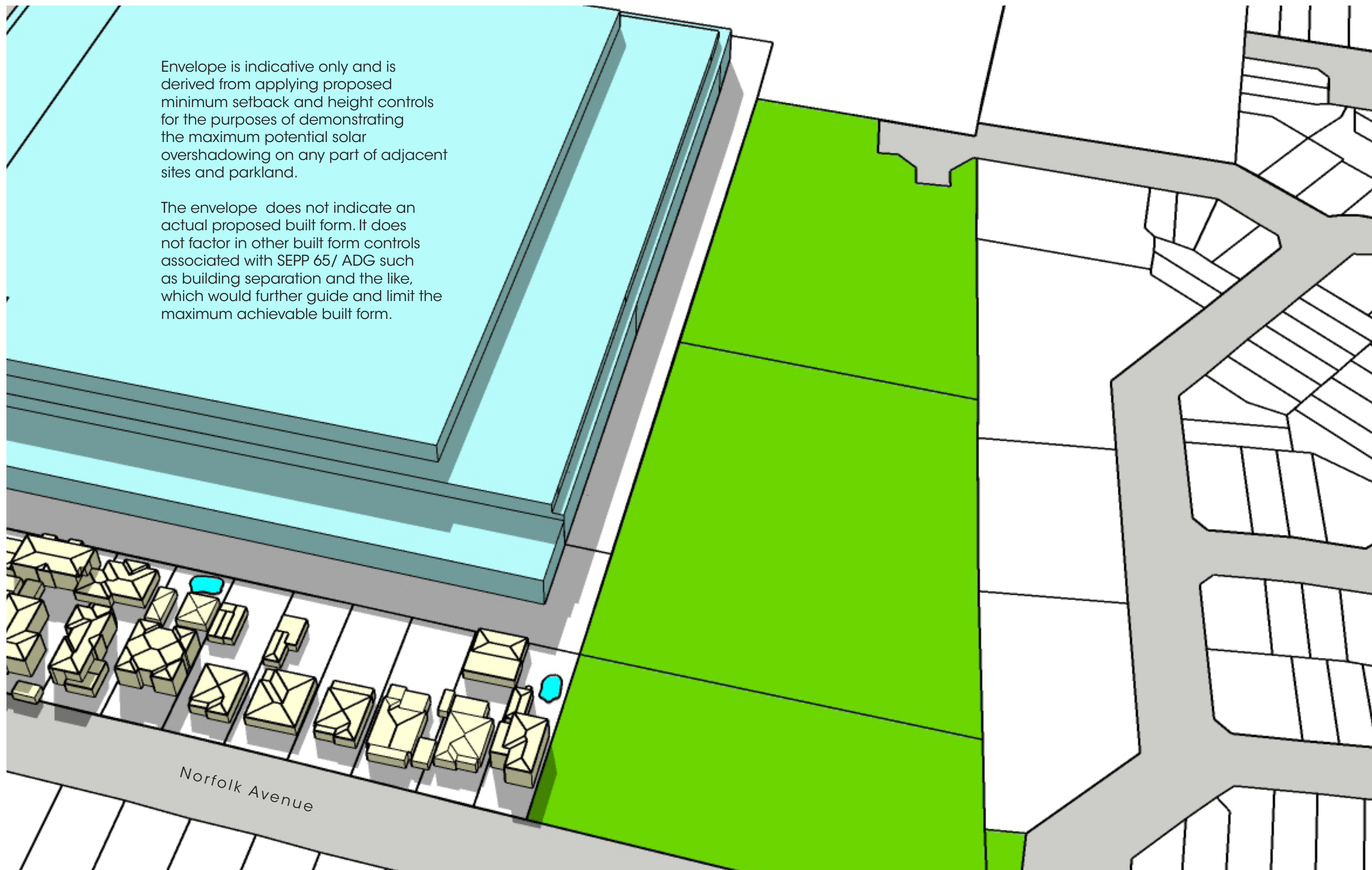

Envelope is indicative only and is derived from applying proposed minimum setback and height controls for the purposes of demonstrating the maximum potential solar overshadowing on any part of adjacent sites and parkland.

The envelope does not indicate an actual proposed built form. It does not factor in other built form controls associated with SEPP 65/ ADG such as building separation and the like, which would further guide and limit the maximum achievable built form.

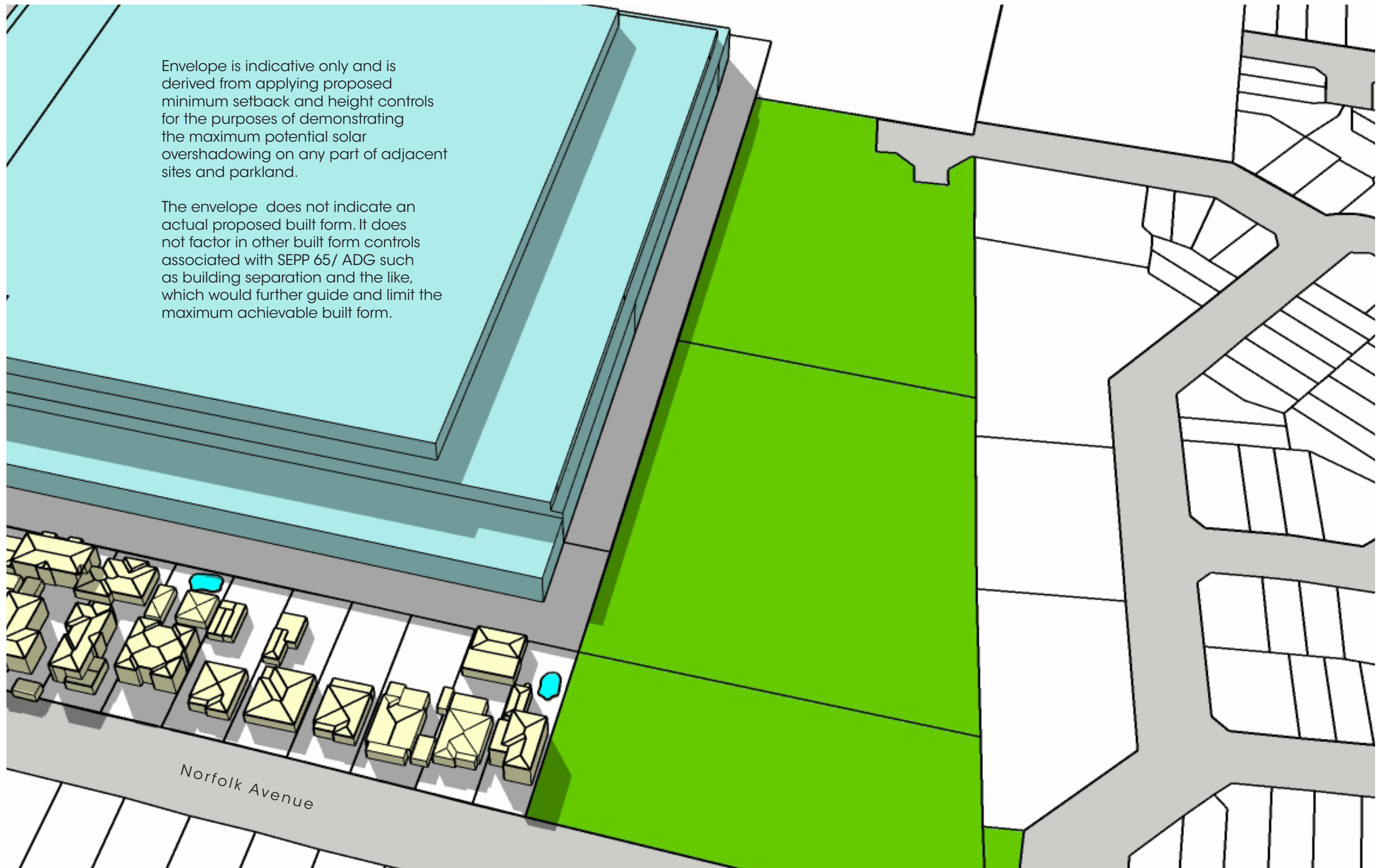

Envelope is indicative only and is derived from applying proposed minimum setback and height controls for the purposes of demonstrating the maximum potential solar overshadowing on any part of adjacent sites and parkland.

The envelope does not indicate an actual proposed built form. It does not factor in other built form controls associated with SEPP 65/ ADG such as building separation and the like, which would further guide and limit the maximum achievable built form.

